

NEW FROM CRL

CRL POSOne

One-Side-Fit Frameless Glass Balustrade System Designed With Installers In Mind

CRL POSOne is our most technically advanced one-side-fit aluminium balustrade system. POSOne has all the benefits and strength of Posiglaze but now it's easier and safer to install. The system is compatible with a large range of finishing accessories including 90° and 135° pre-fabricated corners and Balcony Seal.

It has been tested to BS6180:2011 up to 1.50kN suitable for residential and commercial applications.

- Tested with glass panels up to 1200 mm high.
- Available in Silver and Black.
- Tested to BS 6180:2011

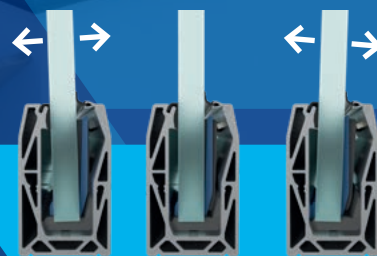

**ONE SIDE FIT - ADJUSTS
UP TO 20MM BOTH SIDES**

For information call **FREE** on **00 800 0421 6144**
Our technical advisers can help you!

e: CRL@crlaurence.co.uk f: [00 800 0262 3299](tel:0080002623299) w: crlaurence.co.uk

CRL®

CRL POSlone is ideal for residential and commercial balustrade installations.

ONE-SIDE FIT

Simple to fit and adjust thanks to its patented screw-clamp technology. One-side-fit reduces cost and safety equipment and glass can easily be removed and replaced.

LIGHTWEIGHT AND STRONG

Precision engineered using extruded aluminium with a geometrically hollowed out core providing an incredible strength to weight ratio anodised to 25 microns.

APPROPRIATE FOR RESIDENTIAL AND COMMERCIAL

With 0.36kN to 1.50kN force loading capability, POSlone is suitable for a wide range of installations.

SUITABLE FOR USE ON UNEVEN SURFACES

The one-side-fit screw-clamp technology provides a 20 mm adjustment angle on both sides of the glass, enabling perfect alignment of each glass panel.

QUALITY ENGINEERING

Tested to BS6180:2011 - 1.50kN for private residential and small commercial applications.

GLASS THICKNESSES

- 12, 15 and 19 mm toughened monolithic glass.
- 13.5, 17.5 and 21.5 mm toughened laminated glass.
- To achieve 1.5 kN line load use 19 mm toughened glass or 21.5 mm Sentry Glass.

TESTED TO
BS 6180:2011



POSlone is so easy to install

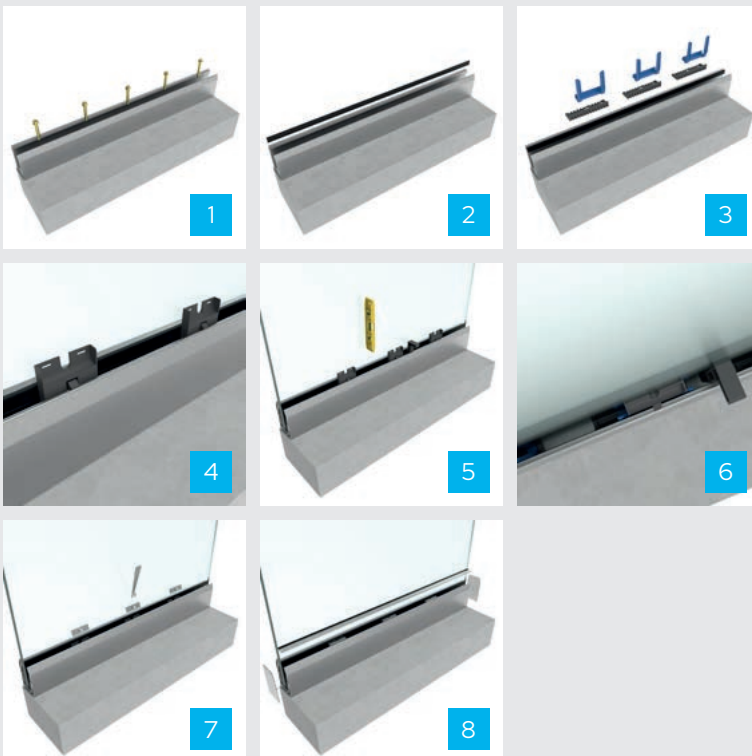

STEP 1

Drill bolt holes into your substrate, first hole 100 mm from the edge then at 200 mm centres. Lay the channel on top and fix in place with an appropriate screw or bolt.

STEP 2

Attach the ridged adjustment bead to outer edge.

STEP 3

Place the isolator and slider into the channel with the wings on the inside and the slider positioned to the right side of the isolator.

STEP 4

Place the glass into the channel.

STEP 5

Insert one wedge tool at each end of the glass and push the clamps down until they reach the clip. Ensure the clamps are within the slider wings.

STEP 6

Manoeuvre the glass into position then slide the clamps to the left so the slider is tight in the required position.

STEP 7

Push the clamps down into the channel. Insert the clamp bars and bolts and tighten them against the channel by unwinding the bolt.

STEP 8

Add the top bead, gasket and end caps.

For information call **FREE** on **00 800 0421 6144**
Our technical advisers can help you!

e: CRL@crlaurence.co.uk f: [00 800 0262 3299](tel:0080002623299) w: crlaurence.co.uk

CRL®